



*Recycle
In
Style!*



After

www.SafePathProducts.com

*Our products are made from
100% post-consumer passenger
and truck tires.*

Choose a color!



Attractive, Safe and Compliant!

StoneCap™ Landings use advanced
technology with ceramic fired quartz
to create an attractive, color fast, slip
resistant surface.

Before



After

www.SafePathProducts.com

More Sustainability... Less Concrete
SAFEPATH
P R O D U C T S

"The Green Alternative to Concrete"

311 Otterson Drive Bldg. 10 • Chico, CA 95928
Tel 530.893.1596 • Fax 530.893.1560
Toll Free 800.497.2003
www.SafePathProducts.com

More Sustainability... Less Concrete

SAFEPATH
P R O D U C T S



"The Green Alternative to Concrete"



**World's Largest
Selection
of Transitions**

1-800-497-2003
www.SafePathProducts.com



www.SafePathProducts.com

Entry Level Landings



www.SafePathProducts.com

SAFEPATH
PRODUCTS

"The Green Alternative to Concrete"



Go Green!

SafePath's™ ramping systems are environmentally sustainable and we are the first to provide green product solutions to multiple surface transitions. Our products are made from 100% post-consumer passenger and truck tires.

Our EntryLevel™ Landings offer a maneuverable level surface and sloped access for a maximum three-sided approach at door thresholds.



www.SafePathProducts.com



We Provide Access!

SafePath™ offers hundreds of product solutions for compliance with the Americans with Disabilities Act (ADA) and access code compliance.



www.SafePathProducts.com



Be Safe!

SafePath's™ products help protect against slip, trip and fall litigation with slip resistant properties. All SafePath™ products meet requirements set forth by the Occupational Safety and Hazard Administration (OSHA) and provide surface properties as recommended by ADA guidelines.



www.SafePathProducts.com

SAFEPATH
PRODUCTS

"The Green Alternative to Concrete"



www.SafePathProducts.com

Walk-Off Matting systems available now!!!

How to Order an EntryLevel Landing

Three Steps:

Step 1. Start off by determining the height of the threshold. Make sure to measure at three locations: the hinge-side of the door, the strike-side and the very center of the door. These will often be the same height, however, if there are varying degrees of slope, use the height of lowest point of the three locations (shim-stock is available to "build-up" the Landing where necessary).



Step 2. Determine the type of Landing and approach your application requires. There are three basic types of Landing configurations: one-sided, two-sided and three-sided approaches. Three-sided Landings are the most popular variety as they allow for three sides of approach into the facility. There are instances where structural impediments exist such as walls, planters or curbing which makes one-sided or two-sided Landings the better option.

One Sided Entry-Level Landing (Front Approach)

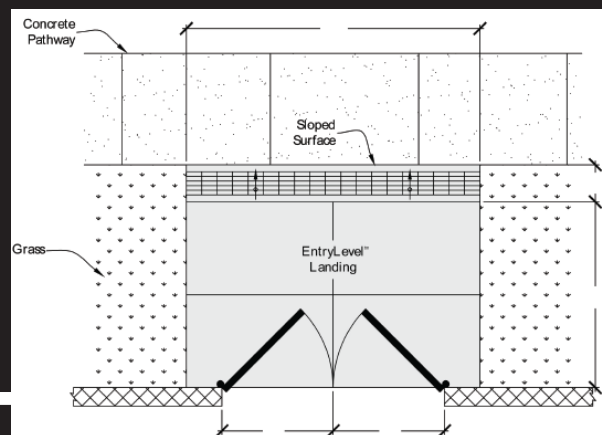

Two Sided Entry-Level Landing (Left Side Approach)

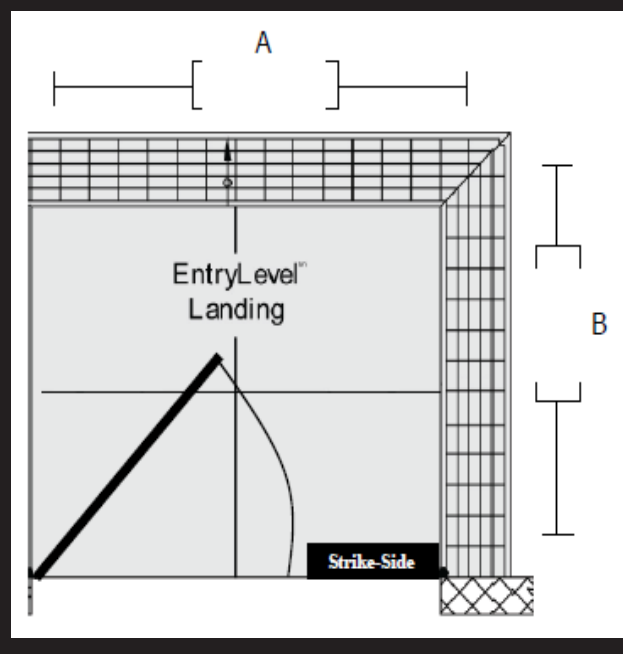

Two Sided Entry-Level Landing (Right Side Approach)

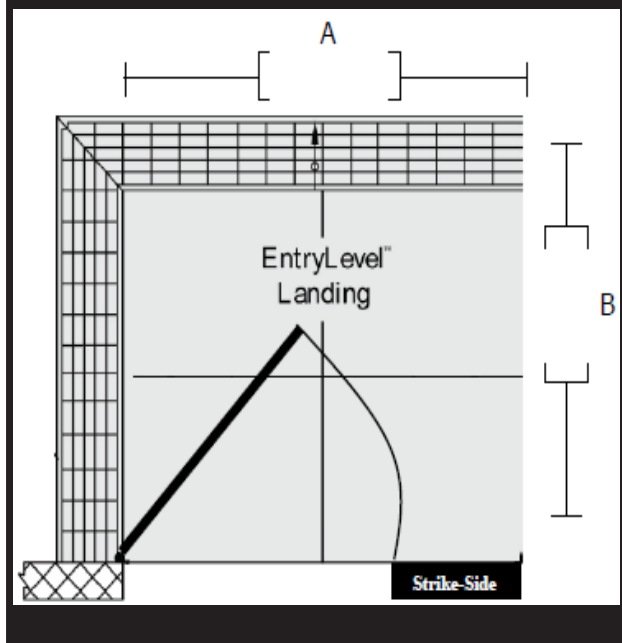



Step 3. Now that the height has been determined, next you will specify the overall square footage (in feet or inches) of the maneuverable level surface. Per federal guidelines for safe accessibility, the measurement of the level surface area is typically 60" x 48", 60" x 60" or 60" x 72", however, custom sizes are available.

The dimensions listed above satisfy most single and double door configurations. There will be instances that require custom sizes. Simply contact our in-house Customization Department for assistance.

To order an EntryLevel Landing, follow the three steps above, then select the SKU that fits your needs.

Denotes the number of approach sides.

Denotes the height.

Denotes the level surface.

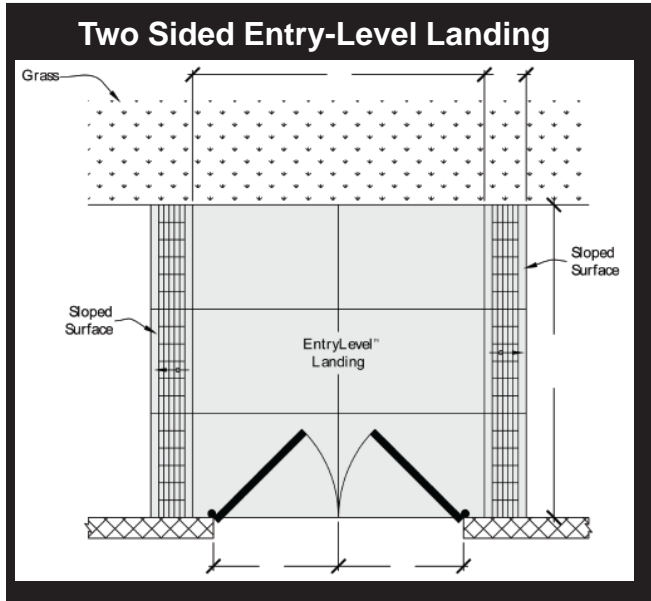

Three Side EntryLevel Landings

EL3 5 6048 B	1/2" x 60" x 48" Black	20	57
EL3 5 6048 C	1/2" x 60" x 48" Coated	20	57
EL3 5 6060 B	1/2" x 60" x 60" Black	25	69
EL3 5 6060 C	1/2" x 60" x 60" Coated	25	69
EL3 5 6072 B	1/2" x 60" x 72" Black	30	80

Three Sided Entry-Level Landing

